



FMA-341N-1

VHF/UHF DIPLEXER



DESCRIPTION

A VHF/UHF Diplexer with a Low Band of 30 to 520 MHz Low Band and a High Band of 806 to 1200 MHz

FEATURES

- A Low Band capable of 250 Watt CW maximum
- A High Band capable of 500 Watt CW maximum

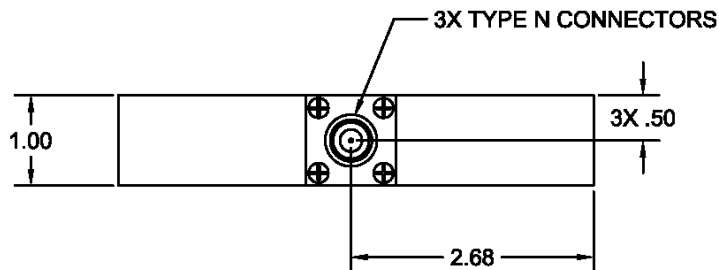
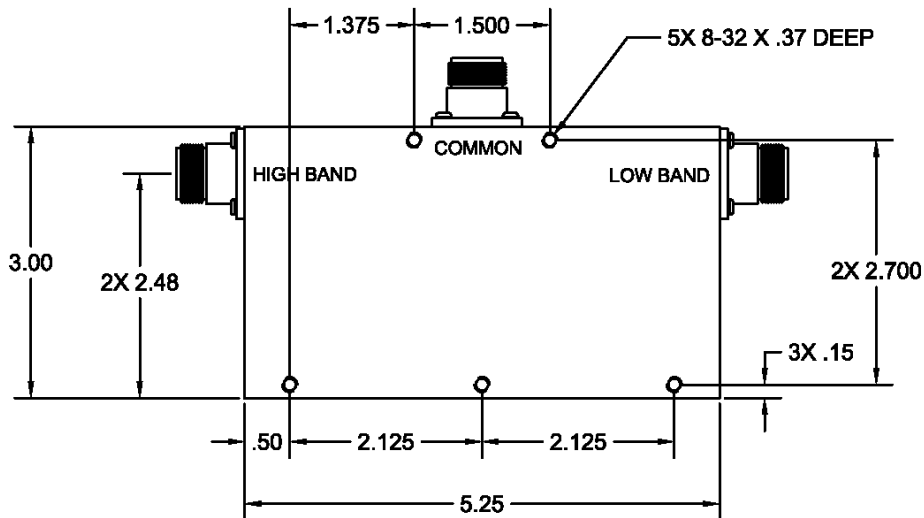

ELECTRICAL SPECIFICATIONS

Low Band to Common

| | |
|----------------------------|-------------|
| Frequency | 30-520 MHz |
| Insertion Loss, 30-520 MHz | 0.5 dB max. |
| Rejection, 950-2260 MHz | 90 dB min. |
| VSWR, Ref. 50 Ohms | 1.5:1 max. |
| Power | 250 W-CW |

High Band to Common

| | |
|------------------------------|--------------|
| Frequency | 806-1200 MHz |
| Insertion Loss, 806-1200 MHz | 0.5 dB max. |
| Rejection, 0-512 MHz | 75 dB min. |
| VSWR, Ref. 50 Ohms | 1.5:1 max. |
| Power | 500 W-CW |

GENERAL CHARACTERISTICS

| | |
|----------------------------|--|
| Weight | 1 lb. 10 oz. nom. |
| Size, excluding connectors | 3.00" x 5.25" x 1.00" |
| Connectors | Type N (Female) |
| Operating Temperature* | -35°C to +85°C |
| Vibration | .036 inch Double Amplitude |
| Shock | MIL-E-5400 par 3.2.21.6.1 10 to 65 Hz |

*External cooling, e.g. heat sink may be required, depending on the transmit power, frequency, and duty cycle.

REV. 3/17/2015