

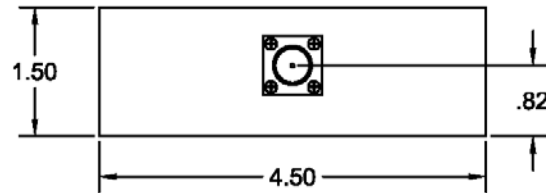

# ET-11

# TRIPLEXER

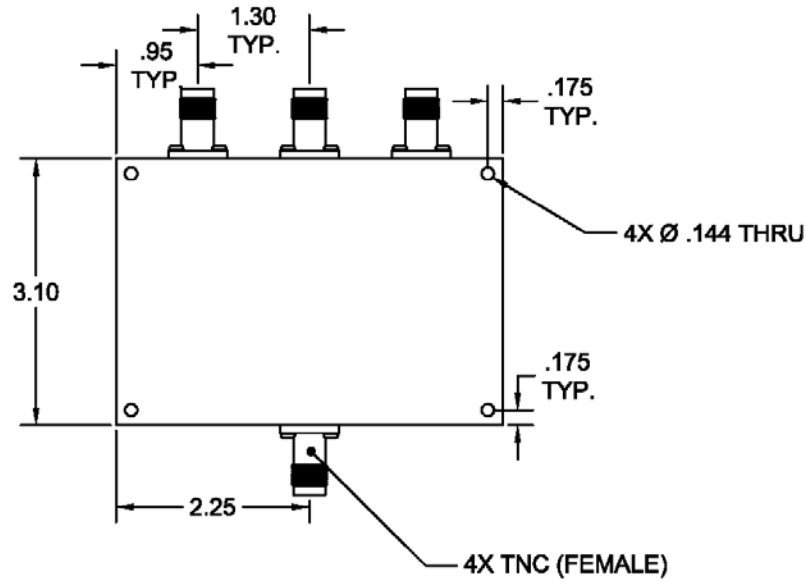

## ELECTRICAL SPECIFICATIONS

Frequency	1400-2300 MHz
Frequency Separation	1% min.
Isolation*	20 dB min.
Insertion Loss*	1.5 dB max.
VSWR	1.5:1 max.
Power	10 W/ CH thru@ critical Alt.

\* Insertion loss and isolation depend on specific channel separation and bandwidth requirements.

## GENERAL CHARACTERISTICS

Size, excluding connectors	4.50" x 3.10" x 1.50"
Weight	28 oz.
Sealing	Hermetic
Connectors	TNC (Female)

REV: 8/29/16